

# AgWest Land Brokers

AgWestLand.com · 866.995.8067

PO Box 1098

Holdrege, NE 68949

\$1,300 / Acre

310.05 ± Acres

Franklin County, NE



Franklin09

**Property Description:** Nice 310 acres of CRP and grassland in Franklin County, NE. Great recreational property for the avid hunter. This property won't last long!

**Location:** From Franklin, NE - Travel east on Highway 136 to 34 Road. Turn north and travel 4 1/2 miles to L Road. Turn east and go 2 miles to 36 road, then turn north on 36 Road and go 1 mile. This will put you on the south end of the property.

**Legal Description:** East 1/2 Section 34 T3N R14W

**2019 Property Taxes:** \$5,252.44

## **CRP Information:**

CRP Contract 384A	125.6 Acres	Annual Payment \$7,662	Expires 9/30/2020
CRP Contract 385A	79.6 Acres	Annual Payment \$4,963	Expires 9/30/2020
CRP Contract 10016A	35.4 Acres	Annual Payment \$2,159	Expires 9/30/2021



**Joel Grams**  
**Farm & Ranch Specialist**  
**308.830.0166**

**Joel.Grams@AgWestLand.com**





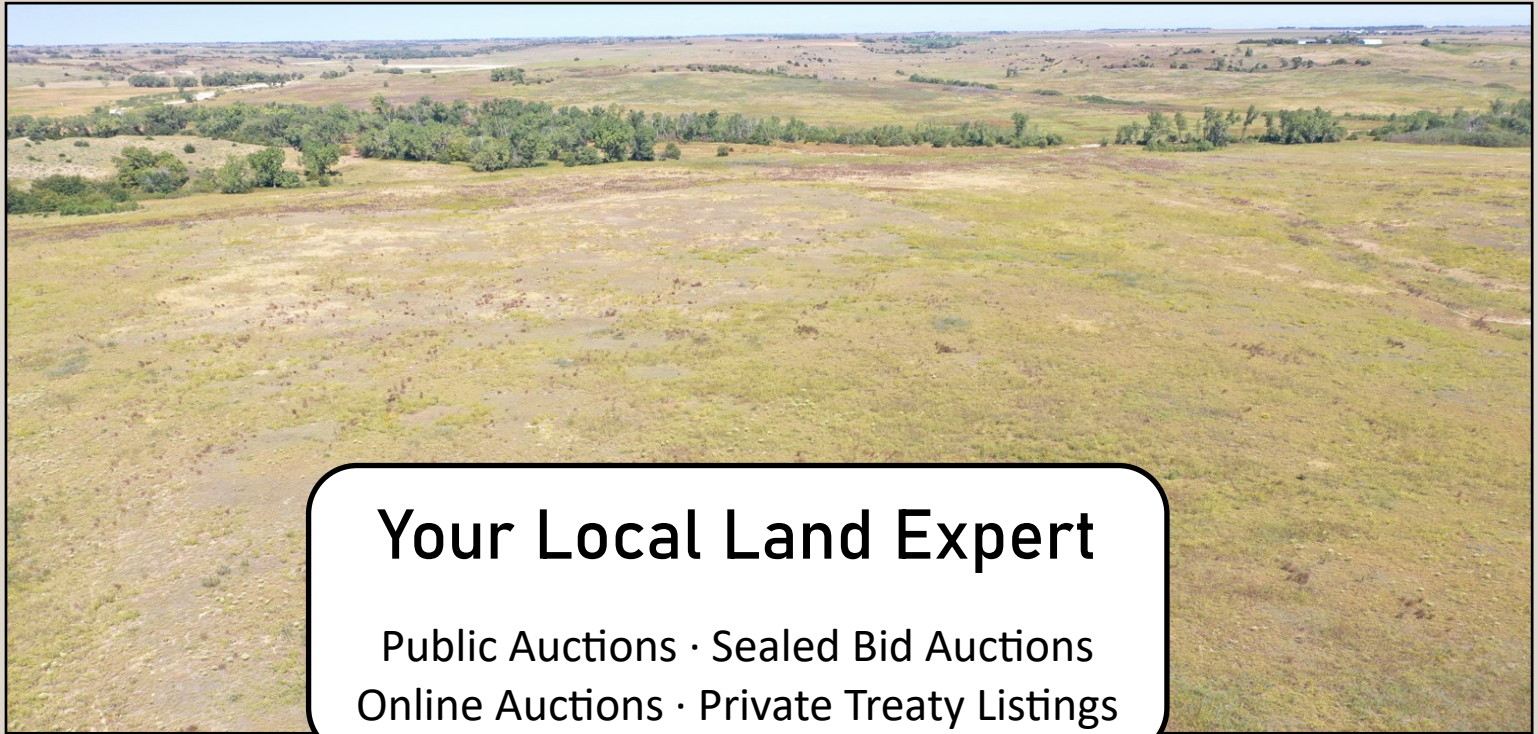

## Your Local Land Expert

Public Auctions · Sealed Bid Auctions  
Online Auctions · Private Treaty Listings

The information contained herein is as obtained by AgWest Land Brokers—Holdrege, NE from the owner and other sources. Even though this information is considered reliable, neither broker nor owner make any guarantee, warranty or representation as to the correctness of any data or descriptions. The accuracy of such statements should be determined through independent investigation made by the prospective purchaser. This offer for sale is subject to prior sale, errors and omissions, change of price, terms or other conditions or withdrawal from sale in whole or in part, by seller without notice and at the sole discretion of seller. Readers are urged to form their own independent conclusions and evaluations in consultation with legal counsel, accountants, and/or investment advisors concerning any and all material contained herein.